

# How To... Glass Cityscapes Starter Kit



*Produces a cityscape scene using Bullseye glass powders, with plenty of powder left over for future projects.*

## In the kit:

3x Bullseye Powder (100g):  
Canary Yellow Opal 0120  
Orange Opal 0125  
Black Opal 0100  
1 x Bullseye White Opal sheet glass (3mm) 15x10cm  
1 x Bullseye Tekta (3mm) 15x10cm  
Powder Ball Sifter  
Plastic Props

## You may also need:

Safety Glasses  
FFP3 Dust Mask  
Paper  
Rubber tipped paintbrush  
Decals  
Glassline Pens  
Bullseye Stringers/Confetti  
Bullseye Clear Powder  
Bullseye Thinfire Paper  
Glass Cleaner  
Kiln and Kiln Shelf

## Tips:

*Try tack fusing the first layer and then adding detail with more powder, Glassline pens, stencils, Bullseye Confetti, candle-bent stringers etc. Then sift a thin layer of clear powder before adding the clear cap glass and firing to a full fuse.*

*Why not add interest such as branches, birds or even hot air balloons with a decal?*

*Use opal powders. Transparents can look washed out when used in thin layers.*

**Need more help?** Take a look at the Knowledge Base on our website.

[www.warm-glass.co.uk](http://www.warm-glass.co.uk)



**Bullseye glass powders are an excellent medium for producing cityscape scenes.**

*This kit contains everything you need to create your own simple cityscape piece. Always wear a dust mask when working with glass powders.*

## To make a basic cityscape scene:

1. Clean the White Opal base glass with a glass cleaner and place on the four plastic props so the glass is raised above the work surface. It is a good idea to put paper underneath to catch any powder.
2. With the powder sifter, sift the Canary Yellow Opal (0120) glass powder over the top edge of the glass to represent the sky. The powder should be at least 2mm thick at the top.
3. Sift the Orange Opal powder a little lower down so it overlaps the yellow layer but so you can still see the yellow powder along the top edge of the glass.
4. Cut out a stencil of a city skyline using paper or card. Gently lay your stencil so that it partly overlaps the orange powder.
5. Sift a thin layer of black powder over the stencil and bottom edge of the glass. Black is a strong colour so you don't need much; just enough to cover the glass underneath.
6. Carefully remove the paper stencil. Use a rubber tipped paintbrush to draw dots in the black powder to create city lights.
7. Cap with the clear glass and fire using the Full Fuse schedule below.

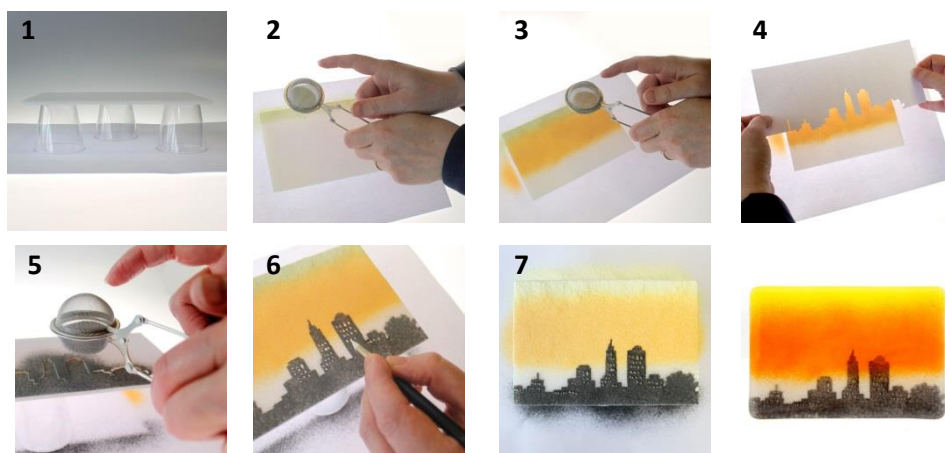

## Full Fuse Firing Schedule (for glass 6mm thick):

Segment	Rate (Degrees/hour)	Temperature	Hold
Segment 1	222°C (400°F)	677°C (1250°F)	30 minutes
Segment 2	333°C (600°F)	804°C (1480°F)	10 minutes
Segment 3	999°C (AFAP)	482°C (900°F)	60 minutes
Segment 4	83°C (150°F)	371°C (700°F)	End